

SSC CHSL

Previous Year Paper

2021

(Held on: 26 May 2022 Shift 1)

English

Combined Higher Secondary Level Examination 2021 Tier I

Roll Number	
Candidate Name	
Venue Name	
Exam Date	26/05/2022
Exam Time	9:00 AM - 10:00 AM
Subject	CHSL 2021 Tier I

Section : English Language

Q.1 Select the option that expresses the given sentence in active voice.
The incident was narrated by somebody to Naresh.

- Ans
- 1. Somebody was narrating the incident to Naresh.
 - 2. Somebody narrated the incident to Naresh.
 - 3. Somebody was about to narrate the incident to Naresh.
 - 4. Somebody will narrate the incident to Naresh.

Question ID : 26433043033
Status : Answered
Chosen Option : 2

Q.2 Select the most appropriate ANTONYM of the highlighted word.
It was an impetuous decision to buy a car when he didn't have a job.

- Ans
- 1. dense
 - 2. arguable
 - 3. tangible
 - 4. sensible

Question ID : 26433045490
Status : Answered
Chosen Option : 4

Q.3 Select the most appropriate option that can substitute the underlined segment in the given sentence.
I was waiting from two hours.

- Ans
- 1. since
 - 2. in
 - 3. for
 - 4. at

Question ID : 26433039697
Status : Answered
Chosen Option : 3

Q.4 Select the most appropriate option to fill in the blank.
My success was complete and the delighted directors _____ me the privilege of developing automatic regulators which were much desired.

- Ans
- 1. contrasted
 - 2. accorded
 - 3. disagreed
 - 4. removed

Question ID : 26433040137
Status : Answered
Chosen Option : 2

Q.5 Select the most appropriate option to fill in the blank.

She was laughing from the _____ exuberance of the performance.

- Ans
- 1. perfect
 - 2. sheer
 - 3. utter
 - 4. total

Question ID : 26433042834
Status : Answered
Chosen Option : 2

Q.6 Select the most appropriate meaning of the given idiom.
Hard and fast

- Ans
- 1. Strict
 - 2. Quick witted
 - 3. Urgent
 - 4. Badly affected

Question ID : 26433043122
Status : Answered
Chosen Option : 1

Q.7 Select the option that can be used as a one-word substitute for the underlined group of words..

Human beings are usually ones who are naturally able to eat both, plants and flesh.

- Ans
- 1. Cannibals
 - 2. Herbivorous
 - 3. Carnivorous
 - 4. Omnivorous

Question ID : 26433045575
Status : Answered
Chosen Option : 4

Q.8 Select the most appropriate meaning of the highlighted idiom.
It was a Catch 22 situation for the manager.

- Ans
- 1. A difficult situation in which the solution to a problem is impossible
 - 2. Hailed as the ultimate champion
 - 3. Worthy successor to the throne
 - 4. A positive outcome in a tough situation

Question ID : 26433045495
Status : Answered
Chosen Option : 1

Q.9 Select the most appropriate option to fill in the blank.

As soon as she opened the cages, the birds _____.

- Ans
- 1. flown away
 - 2. flew away
 - 3. fly away
 - 4. flies away

Question ID : 26433039937
Status : Not Attempted and Marked For Review
Chosen Option : --

Q.10 Select the INCORRECTLY spelt word.

- Ans 1. Appology
 2. Extravert
 3. Lugubrious
 4. Collaborate

Question ID : 26433039802
Status : Marked For Review
Chosen Option : 2

Q.11 Select the option that expresses the given sentence in passive voice.
Siddharth is floating a grand plan by next week.

- Ans 1. Siddharth is being floated by a grand plan next week.
 2. A grand plan is being floated by Siddharth next week.
 3. Next week is keeping afloat by Siddharth's grand plan.
 4. A grand plan is being floating by Siddharth next week.

Question ID : 26433040071
Status : Answered
Chosen Option : 2

Q.12 Select the most appropriate ANTONYM of the highlighted word.
They drank some spurious drink and fainted.

- Ans 1. genuine
 2. curious
 3. nefarious
 4. artificial

Question ID : 26433045493
Status : Answered
Chosen Option : 1

Q.13 Select the most appropriate ANTONYM of the given word.

Former

- Ans 1. External
 2. Additional
 3. Featured
 4. Latter

Question ID : 26433040005
Status : Marked For Review
Chosen Option : 2

Q.14 Select the most appropriate ANTONYM of the given word.
Savage

- Ans 1. Brutal
 2. Civilised
 3. Adequate
 4. Impartial

Question ID : 26433042923
Status : Answered
Chosen Option : 2

Q.15 Select the sentence which has no spelling error.

- Ans 1. Geet runs a pharماسutical chemist shop at New Delhi.
 2. My elder brother works in a pharmaceutical company.
 3. The pharmaetuical company develops and market drugs.
 4. Many phramaeutical companies supplied vaccines in pandemic.

Question ID : 26433043103
Status : Answered
Chosen Option : 2

Q.16 Select the correctly spelt word to fill in the blank.

The _____ of the worksheets is not an easy job.

- Ans 1. reconciliation
 2. reconsiliation
 3. reconsilation
 4. reconciliation

Question ID : 26433042951
Status : Answered
Chosen Option : 4

Q.17 Select the option that expresses the given sentence in passive voice.

You have lost your note book.

- Ans 1. Your note book have been lost.
 2. Your note book has been lost.
 3. Your note book is lost.
 4. Your note book got lost.

Question ID : 26433039947
Status : Answered
Chosen Option : 2

Q.18 Select the most appropriate option to substitute the underline segment in the given sentence.

The affection of her husband carried her up in the midst of all her problems.

- Ans 1. tore her up
 2. bore her up
 3. stood her up
 4. drove her up

Question ID : 26433042822
Status : Answered
Chosen Option : 4

Q.19 Select the most appropriate option to fill in the blank.

The beauty of our festivals lies in 'unity in _____'.

- Ans 1. richness
 2. belongingness
 3. diversity
 4. inclusion

Question ID : 26433045415
Status : Answered
Chosen Option : 3

Q.20 Sentences of a paragraph are given below in jumbled order. Arrange the sentences in the correct order to form a meaningful and coherent paragraph.
A. But while it may seem normal to you, your child may be negatively affected by your and your partner's actions.
B. There is no telling when a squabble between a couple may aggravate and escalate into something ugly, which when witnessed by a child, might devastate them gravely.
C. There's no relationship that does not falter.
D. Arguments, disagreements and conflicts are extremely common even in a healthy relationship.

- Ans 1. CBAD
 2. BCAD
 3. BACD
 4. CDAB

Question ID : 26433039078
Status : Answered
Chosen Option : 4

Comprehension:

In the following passage, some words have been deleted. Read the passage carefully and select the most appropriate option to fill in each blank.
Poetry and novels became very (1)_____ in the 18th century. Robinson Crusoe by Daniel Defoe was published in 1719. This is regarded as the first successful English novel. It is partly based on the true life adventures of a traveller called Alexander Selkirk. Jonathan Swift's Gulliver's travels was written in 1726 and (2)_____ four imaginary journeys of a ship's doctor named Gulliver. Poetry (3)_____ around British people and places. Poets also considered nature as a source of (4)_____. The poets wrote in a simple style and language so that the (5)_____ masses could understand it.

SubQuestion No : 21

Q.21 Select the most appropriate option to fill in blank number 1.

- Ans 1. popular
 2. desired
 3. influential
 4. likely

Question ID : 26433045725
Status : Answered
Chosen Option : 1

Comprehension:

In the following passage, some words have been deleted. Read the passage carefully and select the most appropriate option to fill in each blank.
Poetry and novels became very (1)_____ in the 18th century. Robinson Crusoe by Daniel Defoe was published in 1719. This is regarded as the first successful English novel. It is partly based on the true life adventures of a traveller called Alexander Selkirk. Jonathan Swift's Gulliver's travels was written in 1726 and (2)_____ four imaginary journeys of a ship's doctor named Gulliver. Poetry (3)_____ around British people and places. Poets also considered nature as a source of (4)_____. The poets wrote in a simple style and language so that the (5)_____ masses could understand it.

SubQuestion No : 22

Q.22 Select the most appropriate option to fill in blank number 2.

- Ans 1. describes
 2. represents
 3. discloses
 4. expresses

Question ID : 26433045726
Status : Answered
Chosen Option : 1

Comprehension:

In the following passage, some words have been deleted. Read the passage carefully and select the most appropriate option to fill in each blank.

Poetry and novels became very (1)_____ in the 18th century. Robinson Crusoe by Daniel Defoe was published in 1719. This is regarded as the first successful English novel. It is partly based on the true life adventures of a traveller called Alexander Selkirk. Jonathan Swift's Gulliver's travels was written in 1726 and (2)_____ four imaginary journeys of a ship's doctor named Gulliver. Poetry (3)_____ around British people and places. Poets also considered nature as a source of (4)_____. The poets wrote in a simple style and language so that the (5)_____ masses could understand it.

SubQuestion No : 23

Q.23 Select the most appropriate option to fill in blank number 3.

- Ans 1. revolved
 2. encircled
 3. revolutionised
 4. executed

Question ID : 26433045727
Status : Answered
Chosen Option : 1

Comprehension:

In the following passage, some words have been deleted. Read the passage carefully and select the most appropriate option to fill in each blank.

Poetry and novels became very (1)_____ in the 18th century. Robinson Crusoe by Daniel Defoe was published in 1719. This is regarded as the first successful English novel. It is partly based on the true life adventures of a traveller called Alexander Selkirk. Jonathan Swift's Gulliver's travels was written in 1726 and (2)_____ four imaginary journeys of a ship's doctor named Gulliver. Poetry (3)_____ around British people and places. Poets also considered nature as a source of (4)_____. The poets wrote in a simple style and language so that the (5)_____ masses could understand it.

SubQuestion No : 24

Q.24 Select the most appropriate option to fill in blank number 4.

- Ans 1. incentive
 2. inspiration
 3. impulse
 4. motivation

Question ID : 26433045728
Status : Answered
Chosen Option : 2

Comprehension:

In the following passage, some words have been deleted. Read the passage carefully and select the most appropriate option to fill in each blank.

Poetry and novels became very (1)_____ in the 18th century. Robinson Crusoe by Daniel Defoe was published in 1719. This is regarded as the first successful English novel. It is partly based on the true life adventures of a traveller called Alexander Selkirk. Jonathan Swift's Gulliver's travels was written in 1726 and (2)_____ four imaginary journeys of a ship's doctor named Gulliver. Poetry (3)_____ around British people and places. Poets also considered nature as a source of (4)_____. The poets wrote in a simple style and language so that the (5)_____ masses could understand it.

SubQuestion No : 25

Q.25 Select the most appropriate option to fill in blank number 5.

- Ans 1. modern
 2. traditional
 3. ordinary
 4. typical

Question ID : 26433045729
Status : Answered
Chosen Option : 3

Section : General Intelligence

Q.1 If M denotes '-', N denotes '+', O denotes 'x' and P denotes '+', then what will come in place of '?' in the following equation?
 (38 O 13) N 19 M 27 P (38 O 3) P 43 M 68 = ?

- Ans
- 1. 82
 - 2. 88
 - 3. 92
 - 4. 90

Question ID : 26433043342
 Status : Answered
 Chosen Option : 2

Q.2 Which of the following numbers will replace the question mark (?) in the given series?
 8, 16, 13, ?, 47, 282

- Ans
- 1. 58
 - 2. 48
 - 3. 52
 - 4. 55

Question ID : 26433040570
 Status : Marked For Review
 Chosen Option : 1

Q.3 A paper is folded and cut as shown. How will it appear when unfolded?

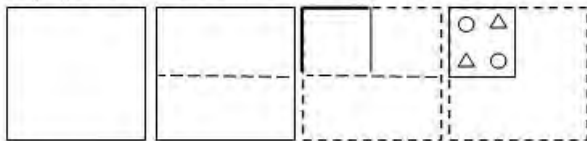

- Ans
- 1.
 - 2.
 - 3.
 - 4.

Question ID : 26433040392
 Status : Answered
 Chosen Option : 2

Q.4 In a certain code language, 'APRON' is written as 'CNTMP' and 'EARTH' is written as 'GYTRJ'. How will 'HEAVY' be written in that language?

- Ans
- 1. JCGUS
 - 2. JGUTA
 - 3. JGCTA
 - 4. JCCTA

Question ID : 26433040140
Status : Answered
Chosen Option : 4

Q.5 Select the option that represents the letters that, when placed from left to right in the given blanks, will complete the letter series.
DE _ WG _ EF _ GDEFU _ D _ FTG

- Ans
- 1. FDGVE
 - 2. FDVGE
 - 3. DFFEVE
 - 4. DVFGE

Question ID : 26433039289
Status : Answered
Chosen Option : 2

Q.6 Select the correct combination of mathematical signs to replace the * signs and to balance the given equation.
 $34 * 4 * 15 * 51 * 27 * 9 * 40$

- Ans
- 1. +, x, -, =, +, +
 - 2. -, +, =, x, -, +
 - 3. +, -, =, x, +, -
 - 4. +, -, x, =, +, -

Question ID : 26433040234
Status : Answered
Chosen Option : 1

Q.7 If 28 February 2017 was Tuesday, then what was the day of the week on 28 February 2019?

- Ans
- 1. Thursday
 - 2. Saturday
 - 3. Friday
 - 4. Monday

Question ID : 26433040665
Status : Answered
Chosen Option : 1

Q.8 How many triangles are there in the given figure?

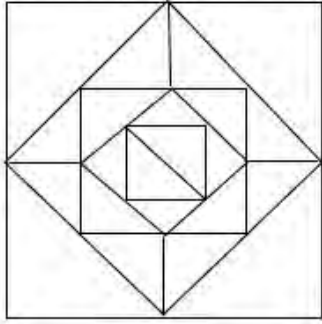

- Ans
- 1. 24
 - 2. 26
 - 3. 28
 - 4. 30

Question ID : 26433040529
 Status : Answered
 Chosen Option : 2

Q.9 Seven friends M, N, O, P, Q, R and S, each has a different age. Only two people are older than Q. P is older than Q but younger than O. M is older than R but younger than S. Only three people are younger than S. N is the youngest among all. The age of how many persons is between the ages of Q and R?

- Ans
- 1. 1
 - 2. 4
 - 3. 3
 - 4. 2

Question ID : 26433043477
 Status : Answered
 Chosen Option : 4

Q.10 Select the correct mirror image of the given combination when the mirror is placed at MN as shown.

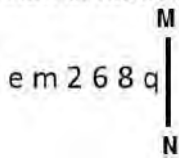

- Ans
- 1. b 8 9 5 m ə
 - 2. q 8 9 5 m ə
 - 3. p 8 ə 5 m ə
 - 4. q 8 9 5 m ə

Question ID : 26433040549
 Status : Answered
 Chosen Option : 3

Q.11 Study the given pattern carefully and select the number that can replace the question mark (?) in it.

First row – 13, 50, 104
Second row – 11, 42, ?
Third row – 18, 70, 144

(NOTE: Operations should be performed on the whole numbers, without breaking down the numbers into its constituent digits. E.g. 13 – Operations on 13 such as adding /deleting /multiplying etc. to 13 can be performed. Breaking down 13 into 1 and 3 and then performing mathematical operations on 1 and 3 is NOT allowed)

- Ans
- 1. 80
 - 2. 96
 - 3. 88
 - 4. 98

Question ID : 26433045252
Status : Answered
Chosen Option : 3

Q.12 09 April 2023 is Friday. What will be 30 April 2023?

- Ans
- 1. Monday
 - 2. Saturday
 - 3. Tuesday
 - 4. Friday

Question ID : 26433040753
Status : Answered
Chosen Option : 4

Q.13 Which letter-cluster will replace the question mark (?) to complete the given series?
XAPE, BIBU, ?, JYZA, NGLQ

- Ans
- 1. YDVQ
 - 2. PSFZ
 - 3. FQNK
 - 4. QNAR

Question ID : 26433044971
Status : Answered
Chosen Option : 3

Q.14 The second number in the given number pairs is obtained by performing certain mathematical operation(s) on the first number. The same operation(s) are followed in all the number pairs, EXCEPT one. Find that odd number pair.

- Ans
- 1. 8 : 64
 - 2. 8 : 512
 - 3. 6 : 216
 - 4. 4 : 64

Question ID : 26433040659
Status : Answered
Chosen Option : 1

Q.15 A paper is folded and cut as shown below. How will it appear when unfolded?

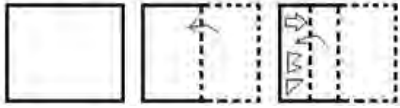

Ans



Question ID : 26433044964

Status : Answered

Chosen Option : 1

Q.16 If I denotes '+', J denotes '×', K denotes '-' and L denotes '+', then what will come in place of '?' in the following equation?
 $37 L 25 K (14 J 2) L (2 J 13) K (62 I 31) = ?$

Ans ✓ 1. 58

✗ 2. 56

✗ 3. 60

✗ 4. 62

Question ID : 26433043349

Status : Answered

Chosen Option : 1

Q.17 In a certain code language, 'DANCE' is written as 'ADNEC' and 'DISCO' is written as 'IDSOC'. How will 'DREAM' be written in that language?

Ans ✗ 1. DREMA

✗ 2. RAEMD

✗ 3. RDEAM

✓ 4. RDEMA

Question ID : 26433045053

Status : Answered

Chosen Option : 4

Q.18 Select the option that is related to the fifth term in the same way as the second term is related to the first term and the fourth term is related to the third term.

GENIUS : IUNGES :: HOLDER : DELHOR :: LIGHTS : ?

Ans 1. HTGLIS

2. TGLHSI

3. TGLSHI

4. HTGLSI

Question ID : 26433040270

Status : Answered

Chosen Option : 1

Q.19 Select the option figure which is embedded in the given figure as its part (rotation is NOT allowed).

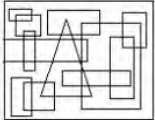

Ans

1.

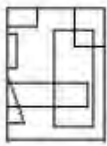

2.

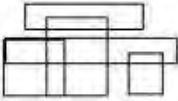

3.

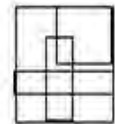

4.

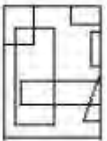

Question ID : 26433040332

Status : Answered

Chosen Option : 1

Q.20 Select the correct combination of mathematical signs to sequentially replace the * signs and to balance the given equation.

$45 * 9 * 3 * 7 * 5 * 133$

Ans 1. -, +, x, +, =

2. -, +, +, x, =

3. x, +, -, +, =

4. +, +, x, -, =

Question ID : 26433040605

Status : Answered

Chosen Option : 3

Q.21 Which of the following numbers will replace the question mark (?) in the given series?
199, 211, 196, ?, 193, 217

- Ans 1. 205
 2. 214
 3. 207
 4. 210

Question ID : 26433040587
Status : Answered
Chosen Option : 2

Q.22 Select the option that is related to the fifth number in the same way as the second number is related to the first number and the fourth number is related to the third number.
19 : 80 :: 23 : 96 :: 16 : ?

- Ans 1. 76
 2. 68
 3. 70
 4. 62

Question ID : 26433043308
Status : Answered
Chosen Option : 2

Q.23 Select the correct combination of mathematical signs to replace the * signs and to balance the given equation.
 $67 * 88 * 8 * 14 * 3 * 19 * 17$

- Ans 1. -, x, =, -, +, +
 2. +, +, -, x, -, =
 3. -, +, x, +, =, -
 4. +, -, =, x, -, x

Question ID : 26433040245
Status : Answered
Chosen Option : 2

Q.24 Select the Venn diagram that best illustrates the relationship between the following classes.

Fruit, Apple, Vegetable

Ans

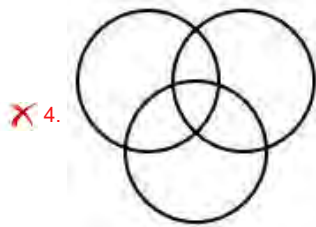
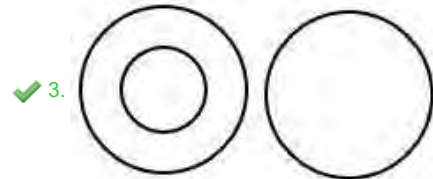
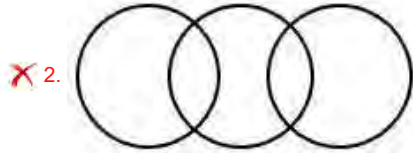
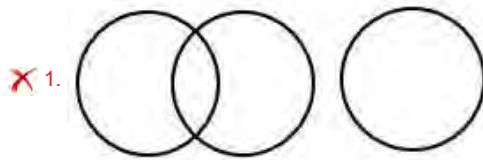

Question ID : 26433040415

Status : Answered

Chosen Option : 3

Q.25 Select the figure from among the given options that can replace the question mark (?) in the following series.

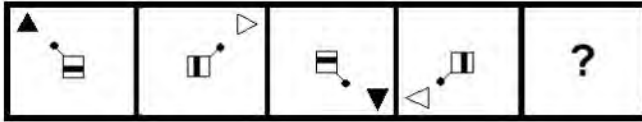

Ans

1.

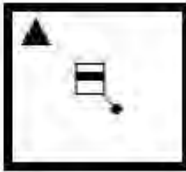

2.

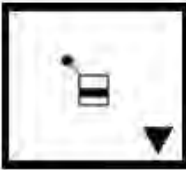

3.

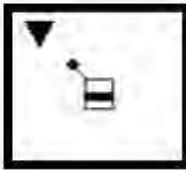

4.

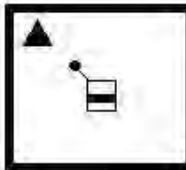

Question ID : 26433045007

Status : Answered

Chosen Option : 4

Section : Quantitative Aptitude

Q.1 The pie-chart given below shows the monthly expenditures made by a family under different heads as percentages of the total monthly income of the family. If the total monthly income of the family is ₹70,000, then what is the amount that is left with the family after only the food and medical expenditures for the month are made?

Expenditure

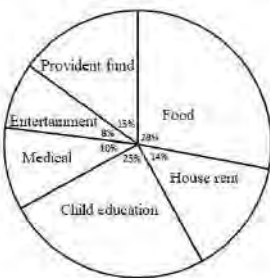

1. ₹43,500

2. ₹43,600

3. ₹43,400

4. ₹43,700

Question ID : 26433045927

Status : Answered

Chosen Option : 3

Q.2 The speed of a boat is 12 km/h in still water. It goes 18 km downstream and comes back in a total time of $6\frac{6}{7}$ hours. Find the speed of the stream (in km/h).

- Ans**
- 1. 1.6
 - 2. 2.7
 - 3. 3.8
 - 4. 4.9

Question ID : 26433042445
Status : Answered
Chosen Option : 4

Q.3 The table below gives the numbers of three types of trees that were planted by government agencies in six consecutive years.

Year	Banyan	Neem	Teak
2013	30000	25000	15000
2014	35000	30000	5000
2015	35000	45000	10000
2016	40000	40000	25000
2017	45000	55000	35000
2018	55000	50000	40000

What was the percentage increase in the number of teak trees that were planted by these agencies in 2017 compared to the number of teak trees that were planted by these agencies in 2016?

- Ans**
- 1. 35%
 - 2. 30%
 - 3. 44%
 - 4. 40%

Question ID : 26433045902
Status : Answered
Chosen Option : 4

Q.4 If $\frac{x^2}{y^2} + \frac{y^2}{x^2} = 7$, A Possible of $\frac{x^3}{y^3} + \frac{y^3}{x^3}$ is:

- Ans**
- 1. 18
 - 2. 15
 - 3. 16
 - 4. 17

Question ID : 26433044161
Status : Answered
Chosen Option : 1

Q.5 After allowing 15% discount, a dealer wishes to sell a machine for ₹1,22,700. At what price must the machine be marked? (Consider up to two decimals)

- Ans**
- 1. ₹1,22,352.94
 - 2. ₹1,44,352.94
 - 3. ₹1,48,352.94
 - 4. ₹1,36,352.94

Question ID : 26433042616
Status : Answered
Chosen Option : 2

Q.6

If $\frac{8r}{r^2 - 8r + 1} = \frac{1}{14}$, then the value of $(r + \frac{1}{r})$ is _____.

- Ans
- 1. 88
 - 2. 100
 - 3. 120
 - 4. 60

Question ID : 26433042657
Status : Answered
Chosen Option : 3

Q.7 The average weight of 15 athletes and three trainers is 60 kg. When four more athletes of average weight 63 kg are included in the group, what is the average weight (in kg, rounded off to the nearest integer) of the group?

- Ans
- 1. 61
 - 2. 62
 - 3. 59
 - 4. 60

Question ID : 26433038613
Status : Marked For Review
Chosen Option : 1

Q.8

If $[3\frac{6}{7} \div \frac{54}{7} - \{3 - (2\frac{3}{4} - \frac{3}{2})\}] + A \div 4 = 0$, then what is the value of A?

- Ans
- 1. 9
 - 2. 6
 - 3. 5
 - 4. 4

Question ID : 26433041414
Status : Answered
Chosen Option : 3

Q.9 How many 25 cm × 11.25 cm × 6 cm bricks will be required to construct an 8 m × 6 m × 22.5 cm wall?(ignoring other material used)

- Ans
- 1. 7020
 - 2. 6400
 - 3. 5800
 - 4. 6800

Question ID : 26433044066
Status : Answered
Chosen Option : 2

Q.10 If triangles ABC and PQR are both isosceles with AB=AC and PQ=PR, respectively. If also AB=PQ and BC=QR and angle B=50°, then what is the measure of angle R?

- Ans
- 1. 50°
 - 2. 80°
 - 3. 90°
 - 4. 60°

Question ID : 26433044363
Status : Answered
Chosen Option : 1

Q.11 A dealer professes to sell his goods at cost price, but uses 900 gm weight for a kilogram. Find his profit per cent.

- Ans
- 1. 9%
 - 2. $11\frac{1}{9}\%$
 - 3. $10\frac{1}{9}\%$
 - 4. 10%

Question ID : 26433042513
Status : Answered
Chosen Option : 2

Q.12 The average marks scored by a student in 4 subjects is 75. But when the marks of English are added to it, the overall average became 70. How much did he score in English?

- Ans
- 1. 50
 - 2. 60
 - 3. 55
 - 4. 65

Question ID : 26433042373
Status : Answered
Chosen Option : 1

Q.13 Find the greatest among the following options.

- Ans
- 1. 0.62
 - 2. $\frac{2}{3}$
 - 3. 0.57
 - 4. $\frac{4}{5}$

Question ID : 26433043903
Status : Answered
Chosen Option : 4

Q.14 If $P : Q = 10 : 11$ and $Q : R = 11 : 12$, then $P + Q : Q + R : R + P$ is:

- Ans
- 1. 21 : 23 : 22
 - 2. 22 : 21 : 23
 - 3. 11 : 12 : 10
 - 4. 23 : 22 : 21

Question ID : 26433039167
Status : Answered
Chosen Option : 1

Q.15 The total surface area of a solid hemisphere is 16632 cm^2 . Its volume is: (Take $\pi=22/7$)

- Ans
- 1. 145232 cm^3
 - 2. 140232 cm^3
 - 3. 150032 cm^3
 - 4. 155232 cm^3

Question ID : 26433039183
Status : Answered
Chosen Option : 4

Q.16 How many two-digit numbers are divisible by 3 or 5?

- Ans
- 1. 48
 - 2. 41
 - 3. 42
 - 4. 40

Question ID : 26433042506
Status : Answered
Chosen Option : 3

Q.17 The price of an article is raised by 45% and then two successive discounts of 15% each are allowed. Ultimately the price of the article is _____.

- Ans
- 1. decreased by 7.7625%
 - 2. increased by 4.7625%
 - 3. decreased by 4.7625%
 - 4. increased by 7.7625%

Question ID : 26433042615
Status : Answered
Chosen Option : 3

Q.18 What is the volume of the largest right circular cone that can be cut out from a cube whose edge is 10 cm?

- Ans
- 1. $\frac{250 \pi}{3} \text{ cm}^3$
 - 2. $\frac{351 \pi}{3} \text{ cm}^3$
 - 3. $\frac{145 \pi}{3} \text{ cm}^3$
 - 4. $\frac{150 \pi}{3} \text{ cm}^3$

Question ID : 26433044131
Status : Answered
Chosen Option : 1

Q.19 The difference between the compound interest and the simple interest on a given principal is ₹1,725 in 2 years and the rate of interest in both cases is 25% per annum, and in the case when interest is compounded, it is compounded annually. Find the principal.

- Ans
- 1. ₹25,600
 - 2. ₹26,500
 - 3. ₹26,400
 - 4. ₹27,600

Question ID : 26433042438
Status : Answered
Chosen Option : 4

Q.20 If $2a+5b=12$ and $ab=3$, find the value of $4a^2 + 25b^2$.

- Ans
- 1. 64
 - 2. 44
 - 3. 84
 - 4. 24

Question ID : 26433042752
Status : Answered
Chosen Option : 3

Q.21 The given circle graph shows the spending of a country on various sports during a year. Study the graph carefully and answer the question that follows.

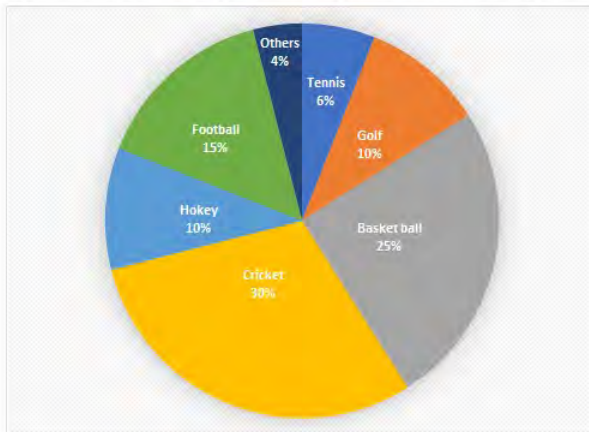

The country spent the same amount of money on:

- Ans
- 1. Cricket and Football
 - 2. Golf and Basketball
 - 3. Hockey and Tennis
 - 4. Hockey and Golf

Question ID : 26433039182
Status : Answered
Chosen Option : 4

Q.22 X's salary is increased by 20% and then decreased by 20%. What is the change in salary?

Ans 1. 4% decrease

2. 4% increase

3. 2% decrease

4. 2% increase

Question ID : 26433041296

Status : Answered

Chosen Option : 1

Q.23 If Mona and Sona together can finish a typing work in 18 days and Sona alone can finish it in 24 days, find the number of days in which Mona alone can finish the work.

Ans 1. 48

2. 60

3. 64

4. 72

Question ID : 26433044234

Status : Answered

Chosen Option : 4

Q.24 The population of a town is 80,000. It decreases by 8% in the first year and increases by 5% in the second year. What will be the population of the town at the end of 2 years?

Ans 1. 76150

2. 86140

3. 77280

4. 82540

Question ID : 26433044111

Status : Answered

Chosen Option : 3

Q.25 In a ΔABC , right angled at B, if $\tan A = \frac{1}{\sqrt{3}}$, then $\sin A \cdot \cos C + \cos A \cdot \sin C =$

Ans 1. 0

2. 2

3. -1

4. 1

Question ID : 26433044143

Status : Answered

Chosen Option : 4

Section : General Awareness

Q.1 Who among the following is the author of the book 'Fasting, Feasting'?

- Ans
- 1. Preeti Shenoy
 - 2. Anuja Chauhan
 - 3. Namita Gokhale
 - 4. Anita Desai

Question ID : 26433044552
Status : Marked For Review
Chosen Option : 2

Q.2 On the basis of the track width of Indian Railways, what type of gauge is Matheran Hill Railways?

- Ans
- 1. Narrow gauge
 - 2. Medium gauge
 - 3. Broad gauge
 - 4. Standard gauge

Question ID : 26433039486
Status : Not Answered
Chosen Option : --

Q.3 A R Rahman, the famous musician won the 52nd Grammy Award for which of the following songs?

- Ans
- 1. Rubaroo
 - 2. Vande Mataram
 - 3. Jai Ho
 - 4. Dilli 6

Question ID : 26433041723
Status : Marked For Review
Chosen Option : 3

Q.4 Which plateau, with an average elevation of about 600 meters (2000 feet), is bounded by three mountain ranges: the Satpura range to the north and the Eastern and Western Ghats on either side?

- Ans
- 1. Marwar Plateau
 - 2. Meghalaya Plateau
 - 3. Deccan Plateau
 - 4. Chota Nagpur Plateau

Question ID : 26433044788
Status : Answered
Chosen Option : 3

Q.5 Lack of financial discipline by the government can lead to _____.
(A) excess expenditure
(B) inflation

- Ans
- 1. Only B
 - 2. Only A
 - 3. A and B
 - 4. Neither A nor B

Question ID : 26433042121
Status : Marked For Review
Chosen Option : 3

Q.6 Which is a slow cooking process that begins around 320°F, removes water from a sugar and breaks down the sugar into complex polymers with a sweet, nutty, or bitter taste and thus produces a golden-brown to dark brown colour?

- Ans
- 1. Gelatinisation
 - 2. Dextrinisation
 - 3. Caramelisation
 - 4. Maillard reaction

Question ID : 26433044777
Status : Marked For Review
Chosen Option : 2

Q.7 When was the National Hydrogen Mission (NHM) launched?

- Ans
- 1. 1 january 2022
 - 2. 2 October 2020
 - 3. 15 August 2021
 - 4. 26 January 2019

Question ID : 26433042030
Status : Marked For Review
Chosen Option : 4

Q.8 Pandit Bhawani Shankar is a _____ player.

- Ans
- 1. pakhawaj
 - 2. tanpura
 - 3. dholak
 - 4. tabla

Question ID : 26433042258
Status : Not Answered
Chosen Option : --

Q.9 Which cricket player's autobiography is titled '281 and Beyond'?

- Ans
- 1. Anil Kumble
 - 2. Javagal Srinath
 - 3. Virender Sehwag
 - 4. VVS Laxman

Question ID : 26433044544
Status : Answered
Chosen Option : 4

Q.10 What is the name of the traditional Indian sport shown in the picture below?



- Ans
- 1. Chaupar
 - 2. Gilli Danda
 - 3. Malkham
 - 4. Kho Kho

Question ID : 26433042196
Status : Marked For Review
Chosen Option : 3

Q.11 Which of the following is the oldest High Court?

- Ans
- 1. Karnataka High Court
 - 2. Calcutta High Court
 - 3. Allahabad High Court
 - 4. Delhi High Court

Question ID : 26433039640
Status : Answered
Chosen Option : 2

Q.12 Who arranged the elements with chemically similar properties, such as lithium, sodium, and potassium, and showed that the properties of the middle element could be predicted from the properties of the other two?

- Ans
- 1. Johann Dobereiner
 - 2. Lothar Meyer
 - 3. John Newlands
 - 4. Dmitri Mendeleev

Question ID : 26433044728
Status : Marked For Review
Chosen Option : 4

Q.13 Maitya Ram Reang (Satyaram) was conferred with the Padma Shri for his contributions to which of the folk dances?

- Ans
- 1. Hojagiri
 - 2. Gussadi
 - 3. Sattriya
 - 4. Bihu

Question ID : 26433041764
Status : Marked For Review
Chosen Option : 3

Q.14 Which is the first of India's traditional dance to be refashioned as a theatre art and to be exhibited widely both at home and abroad?

- Ans
- 1. Kuchipudi
 - 2. Manipuri
 - 3. Kathakali
 - 4. Bharatanatyam

Question ID : 26433044645
Status : Marked For Review
Chosen Option : 4

Q.15 Which of the following is a meteorological instrument consisting of a funnel-shaped collector attached to a measuring tube used to measure rainfall per unit area at a given time?

- Ans
- 1. Anemometer
 - 2. Sling psychrometers
 - 3. Standard Rain Gauge
 - 4. Hygrometer

Question ID : 26433044780
Status : Marked For Review
Chosen Option : 2

Q.16 Identify the word that means horizontal rows in periodic table.

- Ans
- 1. Groups
 - 2. Orbitals
 - 3. Periods
 - 4. Valence electrons

Question ID : 26433041870
Status : Answered
Chosen Option : 3

Q.17 Who won the Bronze medal in badminton women's singles at Tokyo Olympics 2020?

- Ans
- 1. An Se-Young
 - 2. Chen Yu Fei
 - 3. PV Sindhu
 - 4. Tai Tzu-ying

Question ID : 26433041863
Status : Answered
Chosen Option : 3

Q.18 Which of the following is NOT a symptom of Beriberi caused due to the deficiency of Vitamin B1?

- Ans
- 1. Slowly healing wounds
 - 2. Involuntary eye movement
 - 3. Difficulty speaking
 - 4. Pain in the limbs

Question ID : 26433044838
Status : Marked For Review
Chosen Option : 4

Q.19 'Straight from the Heart: An Autobiography' is an autobiography of which of following sportspersons?

- Ans
- 1. Mahendra Singh Dhoni
 - 2. Sunil Gavaskar
 - 3. Kapil Dev
 - 4. Anil Kumble

Question ID : 26433038744
Status : Marked For Review
Chosen Option : 4

Q.20 Who among the following personalities was awarded the Officer of the Legion of Honour award?

- Ans
- 1. Asha Bhosle
 - 2. Shamshad Begum
 - 3. S Janki
 - 4. Lata Mangeshkar

Question ID : 26433041744
Status : Marked For Review
Chosen Option : 4

Q.21 As per statistics published by National Crime Records Bureau for 2020, which state registered the highest number of crimes against children [Indian Penal Code (IPC) and Special and Local Laws (SLL)]?

- Ans
- 1. Maharashtra
 - 2. Uttar Pradesh
 - 3. Bihar
 - 4. Madhya Pradesh

Question ID : 26433041839
Status : Marked For Review
Chosen Option : 1

Q.22 Padma Bhushan awardee Uma Sharma is a _____ dancer.

- Ans
- 1. Bharatanatyam
 - 2. Odissi
 - 3. Kathakali
 - 4. Kathak

Question ID : 26433042287
Status : Not Attempted and Marked For Review
Chosen Option : --

Q.23 Teejan Bai, Jhaduram Devangan, Ritu Verma, Usha Barle and Shantibai Chelak are famous for which of the following forms of folk music?

- Ans
- 1. Pandavani
 - 2. Lavani
 - 3. Bihugeet
 - 4. Bhatiali

Question ID : 26433041712
Status : Not Answered
Chosen Option : --

Q.24 Which of the following is an adventure sport?

- Ans 1. Snow hockey
 2. Cycling
 3. Paragliding
 4. Paralympics

Question ID : 26433042181
Status : Answered
Chosen Option : 3

Q.25 Veteran classical dance guru from _____, Jatin Goswami was given the National Kalidas Samman for 2017.

- Ans 1. Chhattisgarh
 2. Assam
 3. Odisha
 4. West Bengal

Question ID : 26433044601
Status : Marked For Review
Chosen Option : 2